

# Los Angeles Pierce College North Gym Map

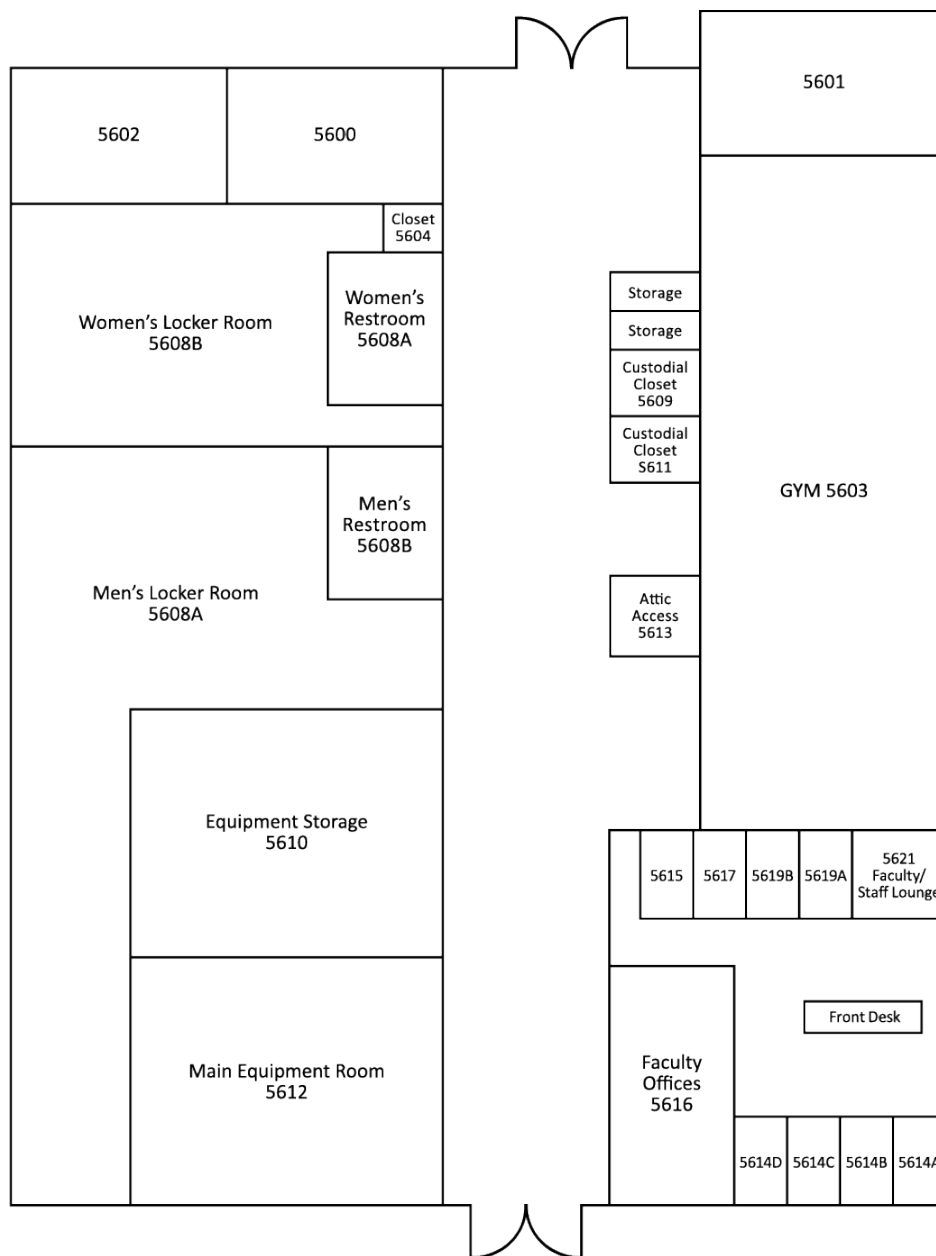

ADA Accessibility for this facility, contact:

ADA Compliance

Paul Nieman, ADA Coordinator

(818) 710-4121

[lapc-ada@piercecollege.edu](mailto:lapc-ada@piercecollege.edu)

Los Angeles Pierce College Kinesiology Department ([Kinesiology Department Web Site](#))

6201 Winnetka Ave. Woodland Hills, California 91371, Office (818) 719-6473